

Dew Point Sensor – K Series

For membrane, drum, refrigerant & hybrid dryers

Key Features

- Dew Point Range:
 - -60°C to +60°C | -76°F to +140°F
- IP65 rating
- Accuracy: $\pm 2\%$
- Power Supply: 10 ... 30 VDC
- Output:
 - Digital: Modbus RTU
 - Analogue: 4...20 mA
- Measure:
 - Pressure Dew Point (PDP), Relative Humidity (RH) and Temperature.
 - Optional: Pressure
- Alarm relay – only available on the 'Dew Point Sensor with Display'



About

This precision dew point sensor is ideal for compressed air and inert gas systems up to 4 Mpa (600psi) with refrigerant, desiccant, hybrid, or membrane dryers.

The optional integrated pressure sensor makes measuring simpler and easier to manage, reducing wiring and installation costs.

With polymer technology and strong contamination resistance, sensor calibration can be performed every 2 years. The fast response time ensures an accurate and up to date reading, giving you peace of mind that your system is under control.

Applications

- Manufacturing and industrial use
- Gas systems up to 4 Mpa (600psi)
- Temporary or permanent installation
- Gas pressure up to 50 bar (725 psi)



More Info

Specifications

Sensor	
Sensor Technology	Polymer sensor
Sensor Filter	Stainless steel mesh filter (filter grade 40-50 µm)

Contact us for other filter options

Measurement Range	
Pressure Dew Point Range	-60°C to +60°C (-76°F to +140°F)
Gas Temperature Measurement Range	-40 to +100 °C -40 to +212°F
Pressure Measurement Range	
• with pressure sensor	0 to 17 bar
• without pressure sensor	0 to 50 bar

Accuracy	
Dew Point Accuracy	±2%
Temperature Accuracy	
• 0 to + 50°C	±0.3°C
• -40 to 0°C and +50 to +100°C	±0.5°C
Pressure Accuracy (@23°C)	±0.3% F.S
Pressure changes with temperature	±0.01 bar / 10°C

Dew Point Measurement Response Time	
-50 to +20 °Ctd	20 sec [40 sec]
+20 to -50 °Ctd	1 min [3 min]

Reference Conditions: 63% [90%], 20 °C, 1bar(a),
4L/min

Working Environment	
Ambient Temperature	-30 to +70°C -22 to +158°F
Relative Humidity	0 to 95% RH
Minimum gas flow	> 1L /min

Output	
Outputs	4-20 mA (3 wire) Modbus RTU (RS485)
Current Output Resolution	0.002 mA
Current Output Temperature Drift	0.01% of span/°C
Current Output Load	Max 500 ohm
Alarm Relay Output	Not available
• Standard Dew Point Sensor	
• Sensor with Display	Normally open 32 VDC/500 mA
Connector	
• Standard Dew Point Sensor	1 x 5 pin M12, female
• Sensor with Display	2 x 5 pin M12, female

Power Supply	
Power Requirement	10 ... 30 VDC
• Standard Dew Point Sensor	Max 50 mA @ 24 V
• Sensor with Display	16 ... 30 VDC Max 150 mA @ 24 V

Electromagnetic Compatibility	Meets IEC 61326-1
-------------------------------	-------------------

Other	
Process Connection	G1/2" thread
Contact us for UNF process connection	

IP Rating	IP65
Casing	
• Standard Dew Point Sensor	Stainless Steel
• Sensor with Display	Anodised Aluminium
Display	
• Standard Dew Point Sensor	NA
• Sensor with Display	1.5" touch screen
HS Code	9025.80.00

Dimensions

Standard Dew Point Sensor

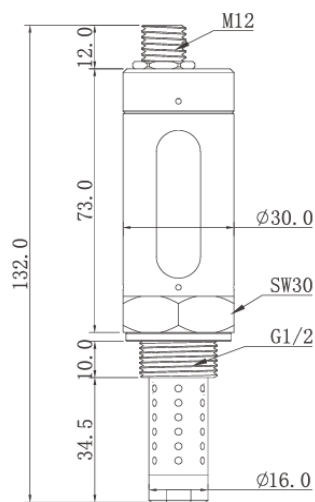

Dew Point Sensor with Display

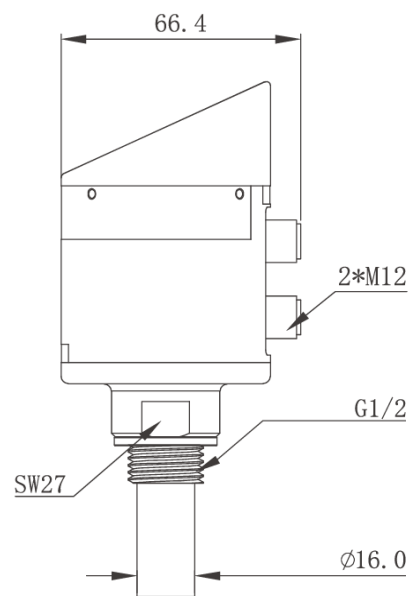
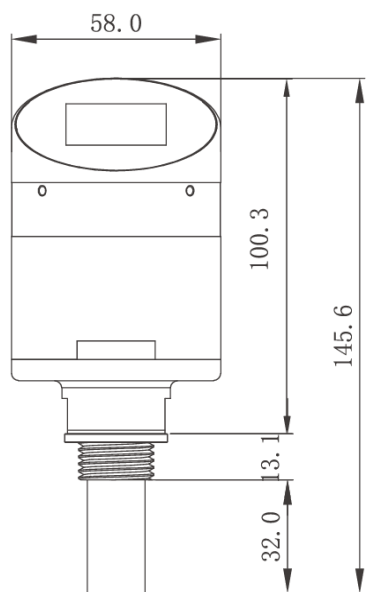

How to Order

Find a Distributor: www.caasensors.com/distributors

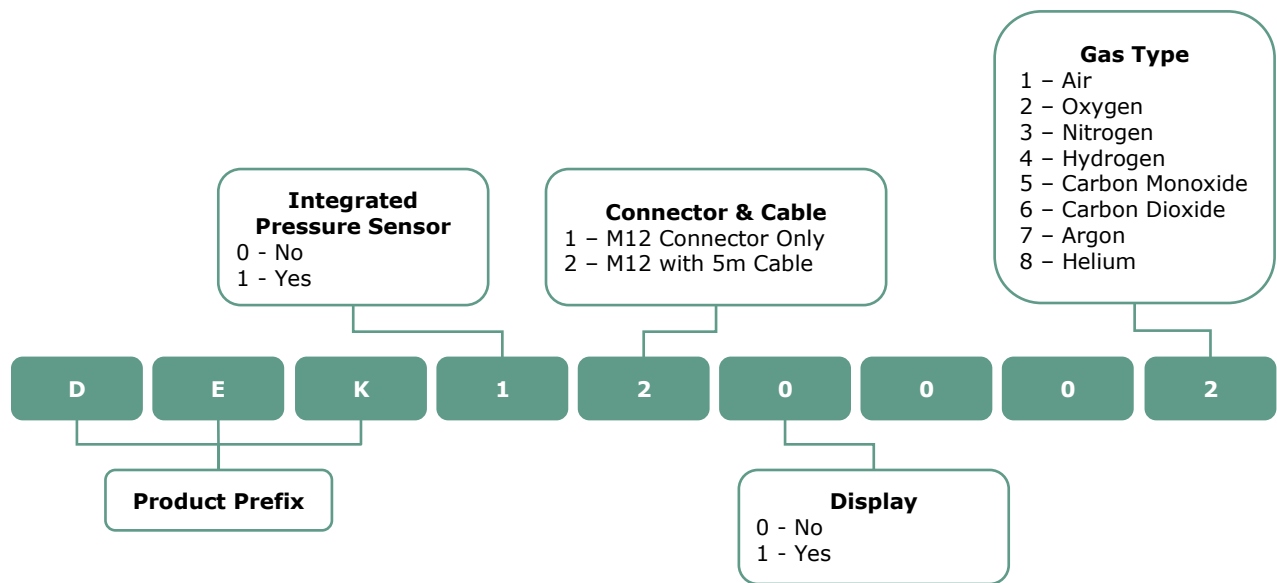

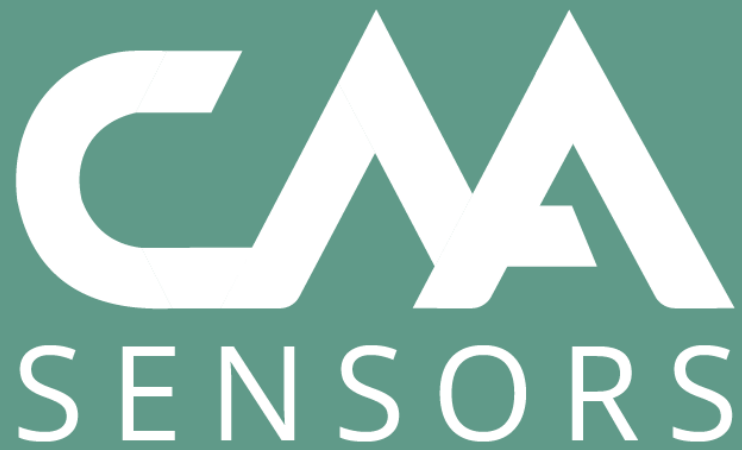

CAA Sensors Pty Ltd

Head Office: Sydney, Australia

Email: sales@caasensors.com

Website: www.caasensors.com

Find a Distributor: www.caasensors.com/distributors